

GN 727

Control knobs with adjustable spindle



GN 727-A

GN 727-B

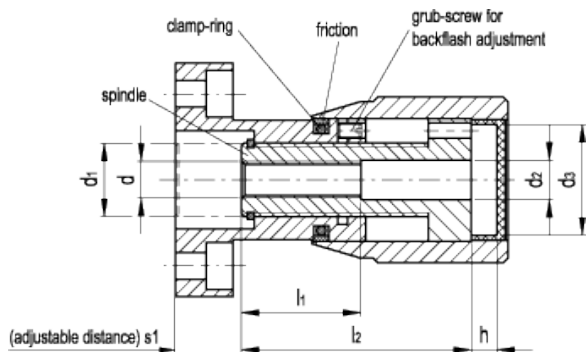
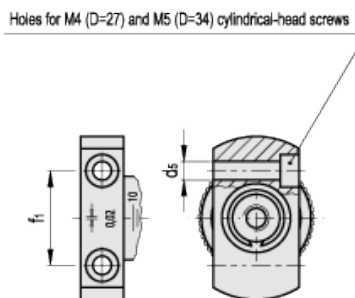
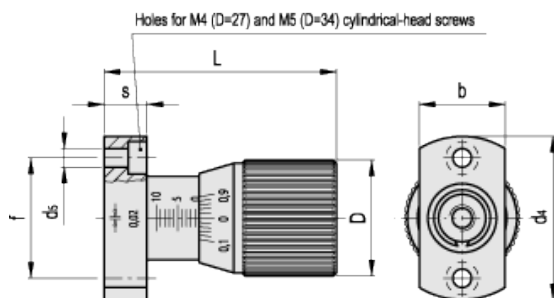

Elesa-Gantergriff		Main dimensions															Weight	
Code	Description	D	L	d	d ₁	d ₂	d ₃	d ₄	d ₅	f	f ₁	l ₁	l ₂	b	h	s	s ₁	g
GN.30561	GN 727-27-A-SR	27	54	M6	M12x1	6.4	18	38	4.3	28	-	19.5	37.5	20	4.3	10	10	110
GN.30562	GN 727-27-B-SR	27	54	M6	M12x1	6.4	18	38	4.3	-	22	19.5	37.5	20	4.3	10	10	105
GN.30571	GN 727-34-A-SR	34	67	M8	M16x1	8.5	23	50	5.3	36	-	23.5	45.5	25	4.2	11	15	210
GN.30572	GN 727-34-B-SR	34	67	M8	M16x1	8.5	23	50	5.3	-	30	23.5	45.5	25	4.2	11	15	200

Base

Chrome-plated steel, matte finish. Assembly by means of two holes for M4 (D=27) or M5 (D=34) cylindrical-head screws.

- GN 727-A: holes for assembly screws parallel to the spindle axis.

- GN 727-B: holes for assembly screws perpendicular to the spindle axis.

Knob

Knurled aluminium profile, anodised, black colour.

Spindle

Natural steel.

Cap

Acetal resin based (POM) technopolymer, light-grey colour. Resistant to solvents, oils, greases and other chemical agents.

Numbering on the base

- 10 marks (D=27) which correspond to 10 knob rotations.
- 15 marks (D=34) which correspond to 15 knob rotations.

Each mark corresponds to 1 mm linear movement.

Values increasing with clockwise rotation.

Black colour laser-engraving in contrast with the chrome-plated surface of the base.

Numbering on the knob

- 50 marks numbered from 0.1 ... to 0.9.

Each mark corresponds to a linear movement by 0.02 mm.

Laser-engraving in contrast with the black surface of the knob.

Special executions on request

- Values increasing with anti-clockwise rotation.

- On the surface of the cap words, marks, graphic symbols, etc... can be tampoprinted in colours.

Features

GN 727 control knobs allow precise adjustment or aligning, for example, of a limit stop device.



STANDAARD MACHINE ELEMENTS WORLDWIDE

ELESA-GANTER models all rights reserved in accordance with the law. Always mention the source when reproducing our drawings.